

# CRATE COLLECTION

PRODUCT FACT SHEET



**HAY**

## CRATE COLLECTION

DESIGN BY GERRIT RIETVELD, RELAUNCHED BY RIETVELD ORIGINALS X HAY IN 2023

Initially designed to make use of surplus wooden shipping crates by Dutch architect and designer Gerrit Rietveld in 1934, the iconic Crate Collection has been relaunched in a Rietveld Originals x HAY collaboration. Rietveld's ambition to create modern, functional, and affordable furniture for the masses echoes HAY's core values, making the Crate Collection an ideal fit for HAY.

The collection comprises a lounge chair, dining chair, low table, and side table, all made with respect for the original design, and sharing the same precisely balanced proportions and transparent construction to minimise production costs and optimise the assembly process. Made of solid pine, with a water-based lacquered finish suitable for outdoor use, the collection's simplicity, and spatial design mirrors the designer's architectural style – providing functionality and comfort without absorbing space. The water-based coating and different colour options make the furniture suitable for a wealth of outdoor settings, and can be supplemented with optional seat cushions in selected textiles for extra comfort.

### HIGHLIGHTS

- An outdoor collection of chairs and tables in varying sizes and colours.
- The collection comprises a Lounge Chair, Dining Chair, Low Table and Side Table.
- Made with respect for the original design sharing the same aesthetic strength and precisely balanced proportions.
- Knock-down construction that only requires screw assembly.
- Made in solid pinewood with a specially developed surface treatment for outdoor use.
- FSC™-certified.
- Suitable for a wide variety of outdoor, private and public environments.
- The wood has been dried to a humidity specifically for outdoor use, which enables it to withstand outdoor conditions. Therefore, we recommend that it is only used outdoors to avoid risk of wood shrinkage.
- Qualified for contract use.

### DIMENSIONS

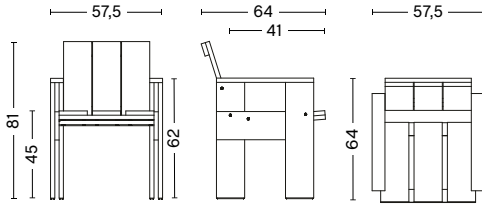

CRATE DINING CHAIR  
WIDTH 57,5 CM | 22.75"  
DEPTH 64 CM | 25.25"  
HEIGHT 81 CM | 32"  
SEAT HEIGHT 45 CM | 17.75"  
SEAT DEPTH 41 CM | 16.25"

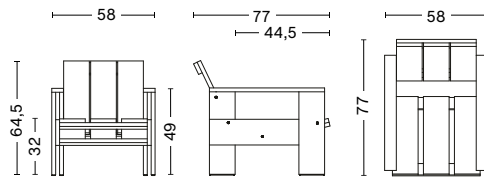

CRATE LOUNGE CHAIR  
WIDTH 58 CM | 22.75"  
DEPTH 77 CM | 30.25"  
HEIGHT 64,5 CM | 25.50"  
SEAT HEIGHT 32 CM | 12.50"  
SEAT DEPTH 44,5 CM | 17.50"

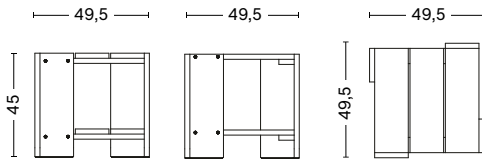

CRATE SIDE TABLE  
WIDTH 49,5 CM | 19.50"  
DEPTH 49,5 CM | 19.50"  
HEIGHT 45 CM | 17.75"

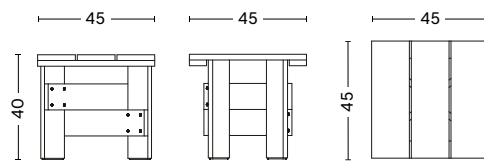

CRATE LOW TABLE  
WIDTH 45 CM | 17.75"  
DEPTH 45 CM | 17.75"  
HEIGHT 40 CM | 15.75"

### MATERIALS

#### CRATE COLLECTION

Solid pinewood with special outdoor surface treatment; a primer and two-layer coating.

#### GLIDER

Black plastic glider.

### OPTIONS

Crate Cushions

### CONSTRUCTION

Crate Side Table is a knock down table with pre-assembled tabletop.

Dining Chair and Lounge Chair are knock down chairs with pre-assembled seat, back and leg sections.

Crate Low Table is fully assembled.

### COUNTRY OF ORIGIN

China

## COLOUR & FINISH

Please note that the colour codes are indicative.



WATER-BASED  
LACQUERED  
PINEWOOD



BLACK  
WATER-BASED  
LACQUERED  
PINEWOOD  
RAL 9005



WHITE  
WATER-BASED  
LACQUERED  
PINEWOOD  
RAL 9003



IRON RED  
WATER-BASED  
LACQUERED  
PINEWOOD  
RAL 8015



LONDON FOG  
WATER-BASED  
LACQUERED  
PINEWOOD  
NCS S 4005-Y20R

## SUSTAINABILITY

HAY focuses on developing long-lasting products that minimise our environmental impact. We optimise the use of sustainable materials such as recycled materials, FSC-certified wood and water-based lacquer, with a growing number of eco-certified products. We have strict regulatory requirements, and the majority of our products are tested to comply with international standards for strength, durability and safety.

[LINK TO ENVIRONMENTAL PROFILE](#)

## CERTIFICATES

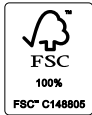

FSC™ LABEL 100%  
Made from FSC™-certified wood.

### TESTS | SEATING

EN 16139:2013

Furniture - Strength, durability and safety - Requirements for nondomestic seating.  
L2: Extreme use - Loading according to Test severity L2.

EN 581-1:2017

Outdoor furniture - Seating and tables for camping, domestic and contract use  
- Part 1: General safety requirements

EN 581-2:2015/AC:2016

Outdoor furniture - seating and tables for camping, domestic and contract use  
- Part 2: Mechanical safety requirements and test methods for seating

### TESTS | TABLES

EN 15372:2016

Furniture - Strength, durability and safety - Requirements for nondomestic tables.  
L3: Severe use.

EN 581-1:2017

Outdoor furniture - Seating and tables for camping, domestic and contract use  
- Part 1: General safety requirements.

EN 581-3:2017

Outdoor furniture - Seating and tables for camping, domestic and contract use  
- Part 3: Mechanical safety requirements for tables.

## CARE & MAINTENANCE

Our Care & Maintenance offers guidance for optimal maintenance of your HAY product. It includes advice and instructions on cleaning and caring for specific materials to prolong the life of your furniture. Find the guide at hay.com.

[LINK TO CARE & MAINTENANCE](#)

## DOWNLOADS

Packshots and lifestyle photos, 2D / 3D files, care and maintenance, instructions, test certificates, product fact sheets, and product presentations are available in our Image Bank at hay.com.

[LINK TO DIGITAL LIBRARY](#)



## CRATE CUSHION COLLECTION

Adding extra comfort and functionality to the Crate Collection, the Crate Cushion is specially formed to fit the chair seat perfectly. Available in three different variants – a loose seat cushion for the Crate Dining Chair, as well as folded and quilted designs for the Crate Lounge Chair. The quilted model features a Velcro® fastening underneath the cushion seat and two straps that fasten around the top of the chair frame, with the seat and folding cushions both featuring an anti-slip bottom to keep them securely in place. All models are crafted in Teflon®-coated fabric for a water-repellent finish, as well as having a high UV resistance, meaning it is fade-resistant with good colour fastness properties. The cushions are available in several colour options and can be used all year round.

### DIMENSIONS

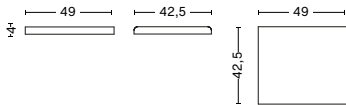

SEAT CUSHION FOR DINING CHAIR

WIDTH 49 CM | 19.25"

DEPTH 42,5 CM | 16.75"

HEIGHT 4 CM | 1.50"

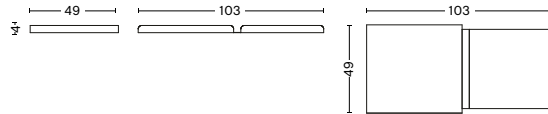

FOLDING CUSHION FOR LOUNGE CHAIR

WIDTH 49 CM | 19.25"

DEPTH 103 CM | 40.50"

HEIGHT 4 CM | 1.50"

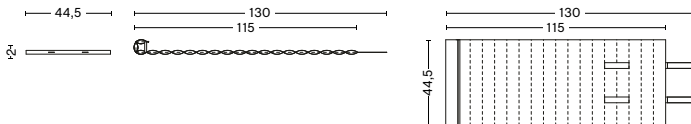

QUILTED CUSHION FOR LOUNGE CHAIR

WIDTH 44,5 CM | 17.50"

DEPTH 130 CM | 51.25"

HEIGHT 2 CM | 0.75"

**MATERIALS | SEAT CUSHION & FOLDING CUSHION**

**FABRIC**

Solution dyed Olefin,  
Teflon® Water Repellent.

**FOAM & FILLING**

20 mm Polyurethane foam.  
20 mm Recycled Polyester fibre wadding.

**BACKING**

Anti-slip recycled PET with biobased  
natural rubber coating, Black

**MATERIALS | QUILTED CUSHION**

**FABRIC**

Solution dyed Olefin,  
Teflon® Water Repellent.

**FOAM**

20 mm Polyurethane foam

**FABRIC COLOUR**

Please note that the colour codes are indicative.



**BEIGE**  
TEXSILK  
UNICOLORS II  
2733



**SKY GREY**  
TEXSILK  
UNICOLORS II  
2649



**ANTHRACITE**  
TEXSILK  
UNICOLORS II  
2657



**IRON RED**  
TEXSILK  
UNI COLORS II  
2230

**SUGGESTED COLOUR MATCH**

Please note that the colour codes are indicative.

		SEATING COLOUR				
		WATER-BASED LACQUERED PINEWOOD	BLACK WATER-BASED LACQUERED PINEWOOD	WHITE WATER-BASED LACQUERED PINEWOOD	IRON RED WATER-BASED LACQUERED PINEWOOD	LONDON FOG WATER-BASED LACQUERED PINEWOOD
CUSHION COLOUR						
			RAL 9005	RAL 9003	RAL 8015	NCS S 4005-Y20R
<b>BEIGE</b> TEXSILK UNICOLORS II 2733		•				
<b>SKY GREY</b> TEXSILK UNICOLORS II 2649				•		
<b>ANTHRACITE</b> TEXSILK UNICOLORS II 2657			•			•
<b>IRON RED</b> TEXSILK UNICOLORS II 2230					•	